

Walking Map

Pharmacy to the Chapel and Back

Lost?

Contact the Information Desk at 603.650.2979.

Route Details

Feet: 1,751
Steps: 700
Miles: .33
Time: 4-6 min

Key

- ⋯ Walking Route
- ★ End of Route
- ⬆ Stairs
- E Elevator
- M W Rest Room

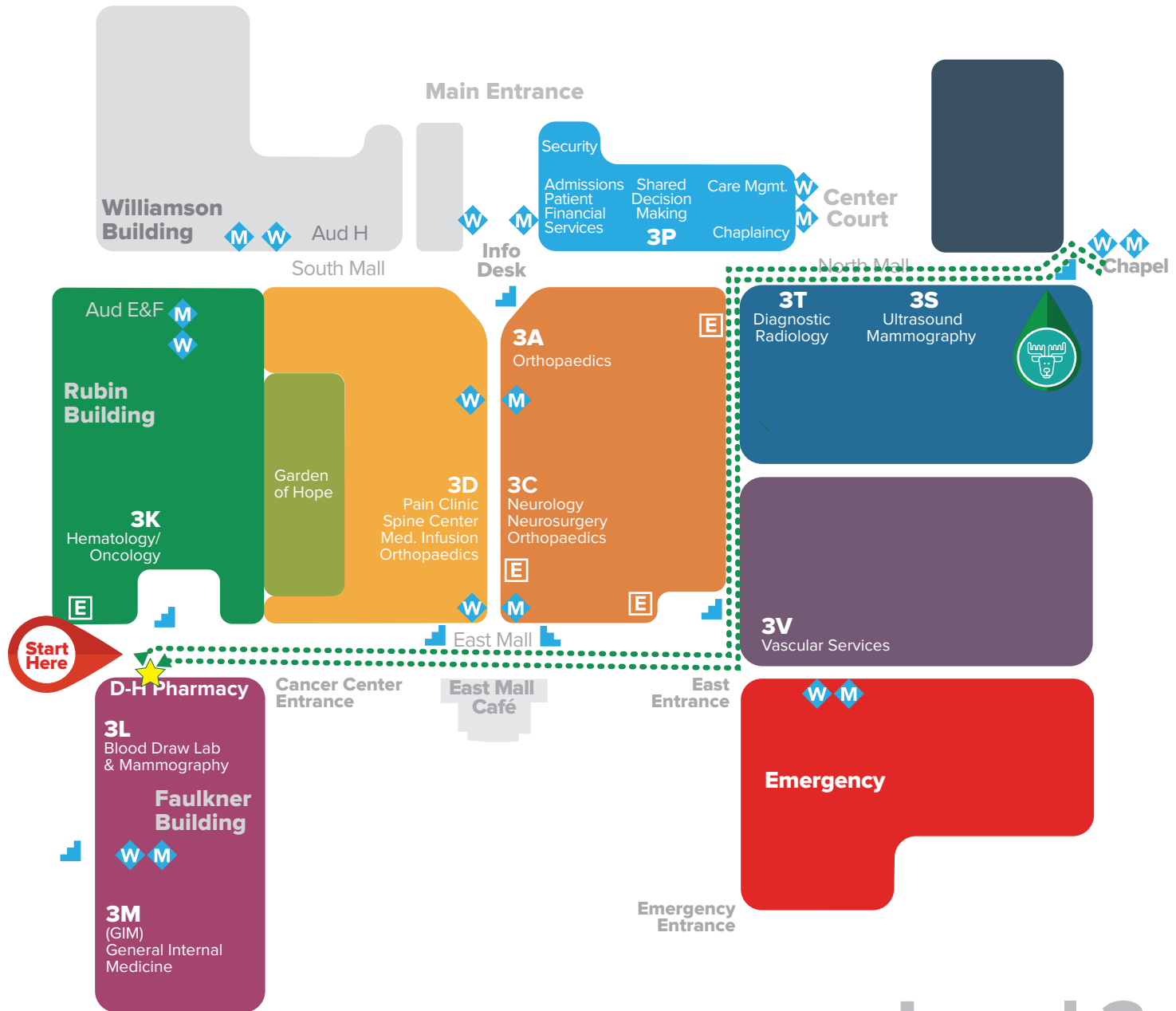

Level 3



1 mile = 5,280 feet / 1,760-2,640 steps / 13-22 minutes